

STELLAR

3 BEDROOMS, 3-4 BATHS, FLEX ROOM, 2 CAR GARAGE, GOLF CART GARAGE

Living Area	2,483 Sq.Ft.
Patio	250 Sq.Ft.
Covered Porch	0 Sq.Ft.
Garage	538 Sq.Ft.
Total	3,271 Sq.Ft.



STRUCTURAL OPTIONS
STELLAR

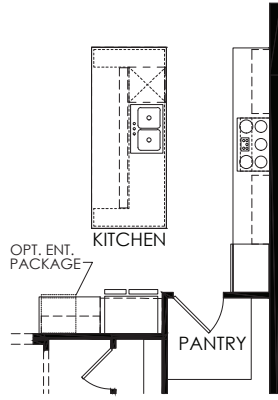

Kitchen Layout 4 and 5

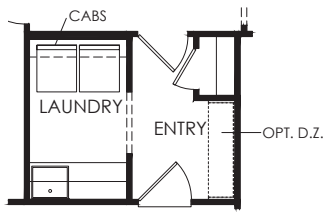

Laundry Upgrade

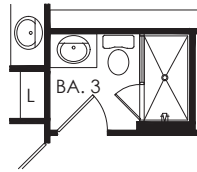

Shower @ Bath 3

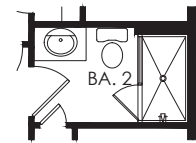

Shower @ Bath 2

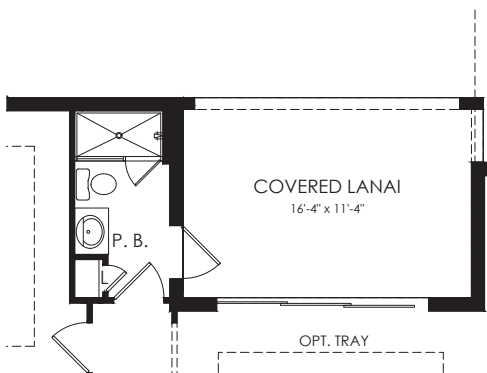

Pool Bath
 Adds 64 SF

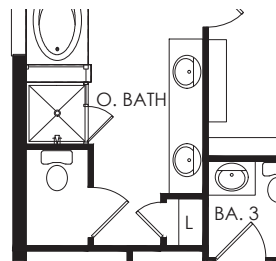

Owner's Bath Layout 3

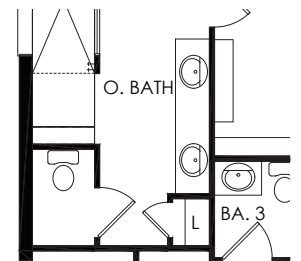

Owner's Bath Layout 4

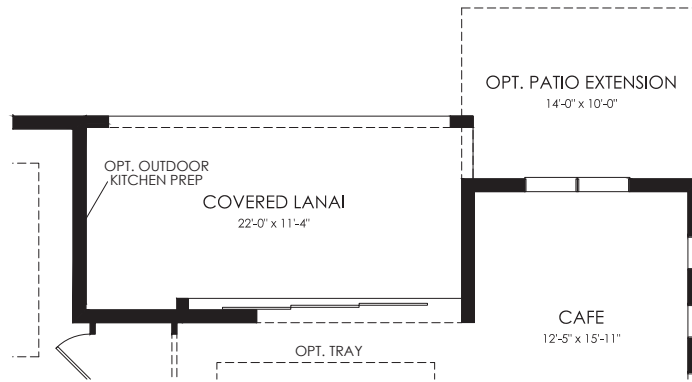

Pocket SGD
at Gathering Room

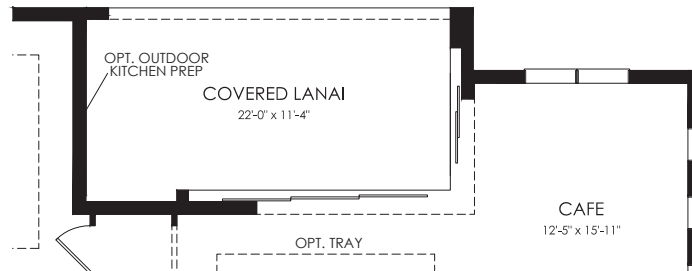

Zero Corner SGD
at Gathering Room

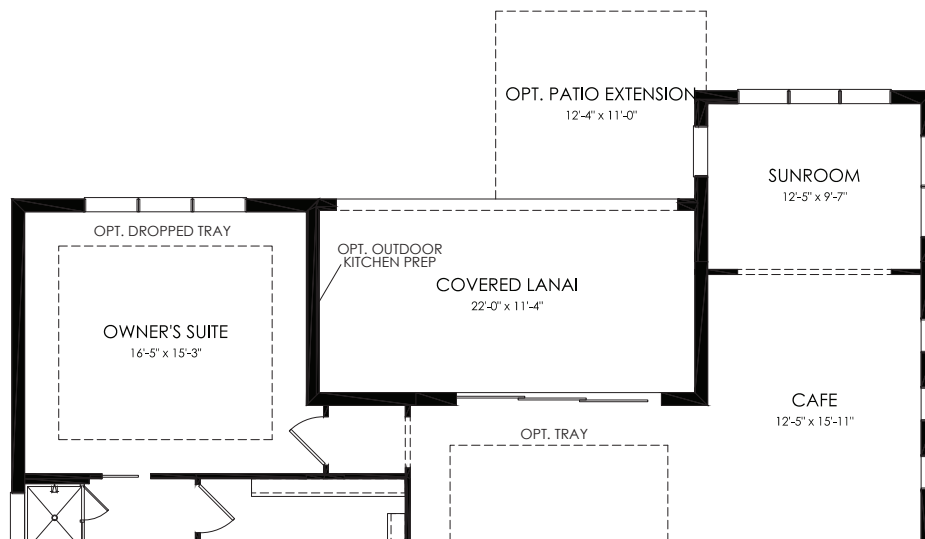

Sunroom
Adds 140 SF